

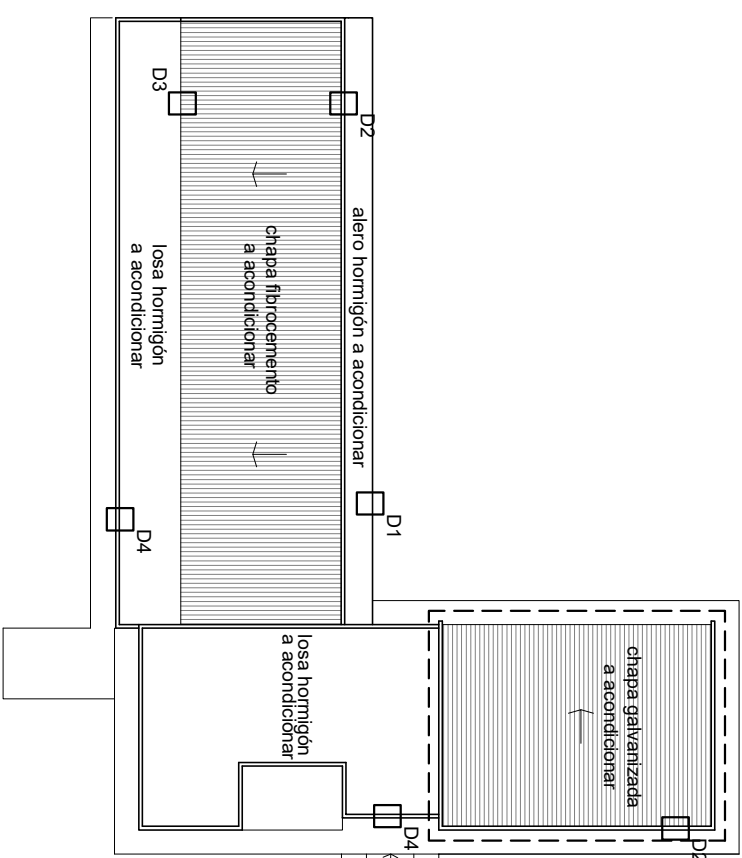

CORTE

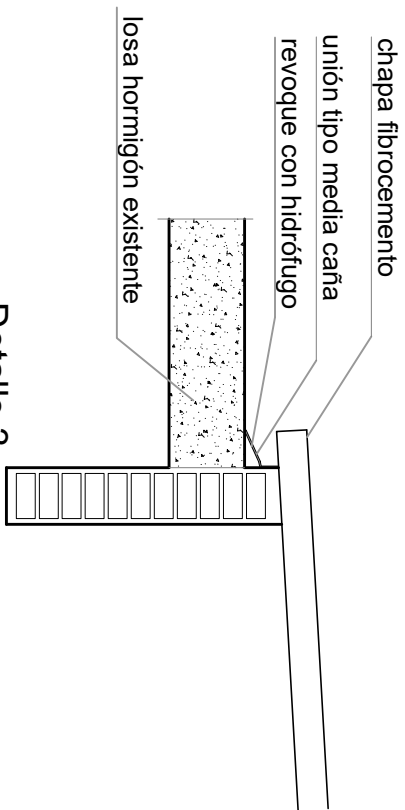
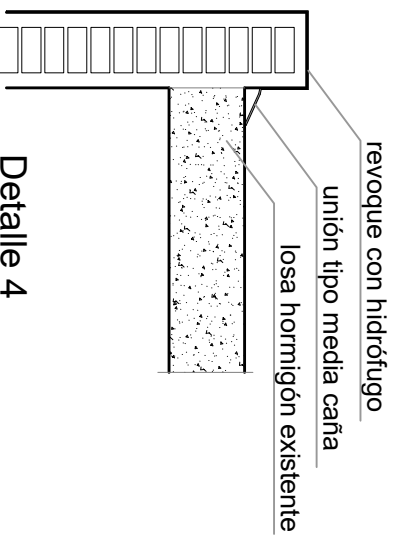
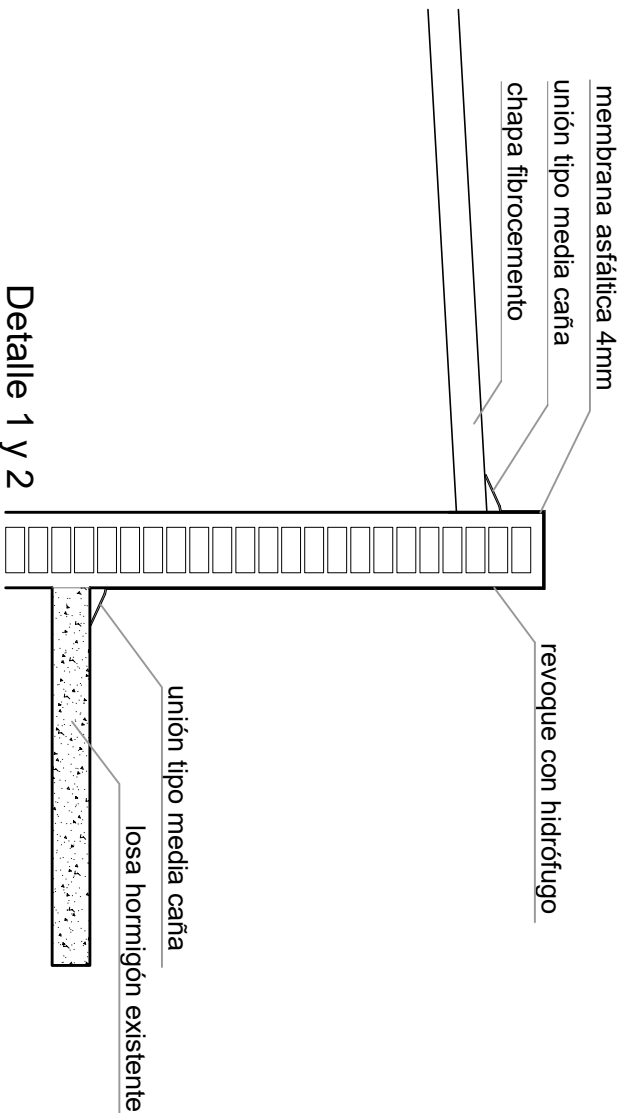

MEDIDAS A RECTIFICAR EN OBRA

| | | | |
|--|------------------------|---------------|---|
|  DIRECCIÓN GENERAL DE EDUCACIÓN INICIAL Y PRIMARIA | | | |
| OBRA: | ESCUELA N° 115 | LOCALIDAD: | CARDONA |
| DIRECCIÓN: | LAVALLEJA Y E. REGULES | DEPARTAMENTO: | SORIANO |
| PLANO DE: ALBAÑILERÍA | | | |
| DETALLES CONSTRUCTIVOS | | | |
| PROYECTO: | ARQ. ALEJANDRA ABELAR | FIRMA: |  |
| AYTE. de ARQTO: | | | |
| TECNICO: | FIRMA: | | |
| LÁMINA N°: L 002 | | | |
| FECHA: 06/2022 | | | |
| ESCALA: - | | | |
| A02 | | | |